

SS-XL Cartridge

Inhibits mineral scale deposits and provides corrosion protection in water-using equipment*



APPLICATIONS

Steamers	Coffee and Espresso Machines
Combi Ovens	Proofers
Ice Machines	Water-Using Equipment

BENEFITS

Increased capacity for locations with increased scale control needs.

Up to 4X the capacity of the SS-IMF (depending on the flow and water quality characteristics).

Features Hydroblend™ compound, a unique blend that inhibits mineral scale deposits and provides corrosion protection in low flow water-fed equipment.*

Patented design (patent no. 5,580,448) dispenses a controlled amount of Hydroblend™ for long-term protection and provides greater effectiveness than standard phosphate treatments.

Unaffected by high temperatures, permitting use in a wide variety of applications.

Translucent cartridge allows simple visual monitoring of product usage and ensures against wasteful premature cartridge replacement.

Integral feed cartridge fits most standard 10-inch housings, all current SR-X housings and all old style AR-X housings.*

The SS-XL ScaleStick® is designed for higher flow rates in Foodservice and light commercial applications.

The SS-XL is ideal for foodservice locations where SS-10 and SS-IMF cartridges are consumed before scheduled maintenance visits.

The SS-XL cartridge's larger diameter makes it suitable for small ware wash applications.

*Not performance tested or certified by NSF.

OPERATIONAL TIPS

Delimiting of equipment prior to application is recommended, but not required.

Inspect ScaleStick cartridges at least every 6 months.

Replace ScaleStick before Hydroblend compound is completely dissolved.



SS-IMF Cartridge: EV9799-42

SPECIFICATIONS

Overall Dimensions:	9.46" H x 2" D (24 x 5.08 cm)
Service Flow Rate:	1.0 - 6 gpm* (3.7 -22.71 Lpm)
Treatment Capacity:	Approximately 12 months. Capacity will vary depending on application and water usage. On flow rates less than 1 gpm, capacities may be reduced*
Maximum Temperature:	150°F* (65.5°C) Note: If inlet water temperature is above 125°F (51.67°C) a hot water housing must be used
Electrical Connection:	None required

SS-XL Filter Cartridge

EV9799-42

INSTALLATION TIPS

The cartridge must be operated vertically.
Shut-off valve must be installed upstream of the filter.

Refer to Installation, Operation & Maintenance Manual for cartridge flushing and start-up.

Pre-existing equipment scale may come loose and clog equipment. Remove any loose scale to assure satisfactory operation.

The contaminants or other substances removed or reduced by this drinking water system are not necessarily in your water. Do not use with water that is microbiologically unsafe or of unknown quality without adequate disinfection before or after the system. Systems certified for cyst reduction may be used with disinfected water that may contain filterable cysts.

Everpure water treatment systems (excluding replaceable elements) are covered by a limited warranty against defects in material and workmanship for a period of five years after date of purchase. Everpure replaceable elements (filter cartridges and water treatment cartridges) are covered by a limited warranty against defects in material and workmanship for a period of one year after date of purchase. See printed warranty for details. Everpure will provide a copy of the warranty upon request.

Everpure reserves the right to update specifications, change prices, or make substitutions without notice.

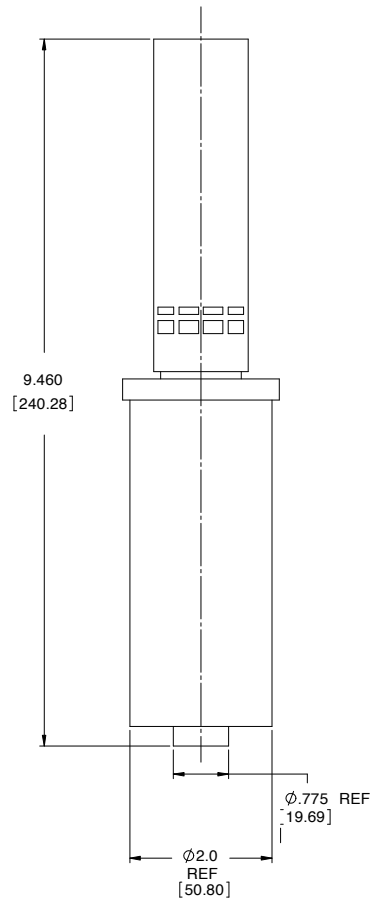

The ScaleStick® trademark is used pursuant to an agreement between PWC Enterprises, Inc. and Pentair Filtration Solutions, LLC.



The SS-XL is Tested and Certified by NSF International against NSF/ANSI Standard 42 for material requirements only.

EV9799-42 SS-XL AP11



Visit our website at www.everpure.com

Pentair Filtration Solutions, LLC
World Headquarters-Everpure/SHURflo

North and South America Sales
1040 Muirfield Dr.
Hanover Park, Illinois 60133
USA

TEL: 800.942.1153 (US only)
TEL: 630.307.3000
FAX: 630.307.3030

EMAIL: cseverpure@pentair.com

Everpure-SHURflo Australia
2 Redwood Drive
Notting Hill
Victoria, 3168
AUSTRALIA

TEL: 011.61.39.574.4000
FAX: 011.61.39.562.7237

EMAIL: au.everpure@pentair.com

Everpure-SHURflo Southeast Asia
18 Boon Lay Way
#04-110/111

TradeHub 21, 609966
SINGAPORE
TEL: 65.6795.2213
FAX: 65.6795.2219

EMAIL: cseverpure@pentair.com

Everpure-SHURflo Europe
Pentair Water Belgium bvba
Industriepark Wolfstee
Toekomstlaan

30 B-2200 Herentals, BELGIUM
TEL: +32.(0).14.283.500
FAX: +32.(0).14.283.505

EMAIL: sales@everpure-europe.com

Everpure-SHURflo India
Green Boulevard, B-9/A, 7th Floor -
Tower B Sector 62, Noida - 201301
TEL: 91.120.419.9444
FAX: 91.120.419.9400
EMAIL: indiacustomer@pentair.com

Everpure-SHURflo Japan Inc.
Hashimoto MN Bldg. 7F
3-25-1 Hashimoto, Midori-ku
Sagamihara-Shi Kanagawa 252-0143
JAPAN
TEL: 81.(0)42.775.3011
FAX: 81.(0)42.775.3015
EMAIL: info@everpure.co.jp

Everpure-SHURflo China
21F Cloud 9 Plaza, No 1118,
Shanghai, 200052
CHINA
TEL: 86.21.3211.4588
FAX: 86.21.3211.4580
EMAIL: China.Water@Pentair.com